

The following catalog
has gaps in its page
numbers, or doesn't
have any numbers.
We have chosen to
leave the page
numbering in the
order that Acrobat
assigns it.

FICHE LOCATION

ILLUSTRATION

1 A3 ***** DATA TABLE

1 C1 ***** BATTERY CHARGER & RUNNING LIGHT GROUP

1 A3 ***** DOLLY GROUP - OPTIONAL

1 A13 ***** END BELL GROUP - BEGIN SPEC E (PC)

1 A13 ***** END BELL GROUP - BEGIN SPEC C (PD-H,K)

1 B5 ***** END BELL GROUP - SPEC D ONLY (PC)

1 B5 ***** END BELL GROUP - SPEC A-B(PD-PH)

1 B1 ***** END RECEPTACLE BOX GROUP (60 HERTZ) - BEGIN SPEC C (PD-H,K)

1 B1 ***** END RECEPTACLE BOX GROUP (60 HERTZ) - BEGIN SPEC E (PC)

1 A5 ***** ENGINE & CARRYING FRAME GROUP

1 A9 ***** GENERATOR GROUP

1 C3 ***** IDLEMATIC CONTROL - OPTIONAL

1 B7 ***** PRINTED CIRCUIT BOARD(300-1185) IDLE-MATIC CONTROL

1 B11 ***** RECEPTACLE BOX ASSEMBLY GROUP - REMOTE - SPEC A-B(PD-PH)

1 B11 ***** RECEPTACLE BOX ASSEMBLY GROUP - REMOTE - SPEC D - PC

1 C5 ***** SERVICE KITS & MISCELLANEOUS

1 B9 ***** SIDE MOUNTED RECEPTACLE BOX GR.(STAND./50;OPT./60) - BEGIN SPEC E(PC)

1 B9 ***** SIDE MOUNTED RECEPTACLE BOX GR.(STAND./50;OPT./60) - BEGIN SPEC C(PD-PH)

To determine correct column in this parts catalog, check generator set nameplate (ONAN) for correct model and generator output. Also determine generator stack length.

DESCRIPTION	QUANTITY USED										
	A	B	C	D	E	F	G	H	J	K	
PD - Use Column A Up to 1000 Watt, 50 Hertz Up to 1200 Watt, 60 Hertz 1-1/2" Generator Stack Length	X										
PC - Use Column B 1001 through 1400 Watt, 50 Hertz 1201 through 1750 Watt, 60 Hertz 2-1/4" Generator Stack Length		X									
PE - Use Column C 1401 through 1600 Watt, 50 Hertz 1751 through 2000 Watt, 60 Hertz 2-1/4" Generator Stack Length			X								
PF - Use Column D 1601 through 2500 Watt, 50 Hertz 2001 through 3000 Watt, 60 Hertz 3" Generator Stack Length				X							
PG - Use Column E 2501 through 3700 Watt, 50 Hertz 3001 through 4500 Watt, 60 Hertz 4-1/2" Generator Stack Length Cast Iron Engine					X						
PH - Use Column F 3701 through 4500 Watt, 50 Hertz 4501 through 6000 Watt, 60 Hertz 6" Generator Stack Length						X					
PK - Use Column G 2501 through 3700 Watt, 50 Hertz 3001 through 4500 Watt, 60 Hertz 4-1/2" Generator Stack Length Aluminum Engine							X				

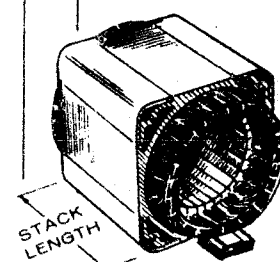

Output receptacles and Voltmeters are located in the output box attached to generator end bell on late model 60 hertz sets. Early models have the receptacles and volt-meter located in the end bell. Some models have the optional separate output box mounted on the top or side of generator. Receptacles are not furnished by Onan on the 50 Hertz sets.

Three voltage ranges are used on 50 hertz sets. Refer to ELECTRIC DATA in the OPERATOR PORTION of this manual for proper identification. The only part change between these voltage ranges is the Stator Assembly.

DOLLY GROUP (OPTIONAL)

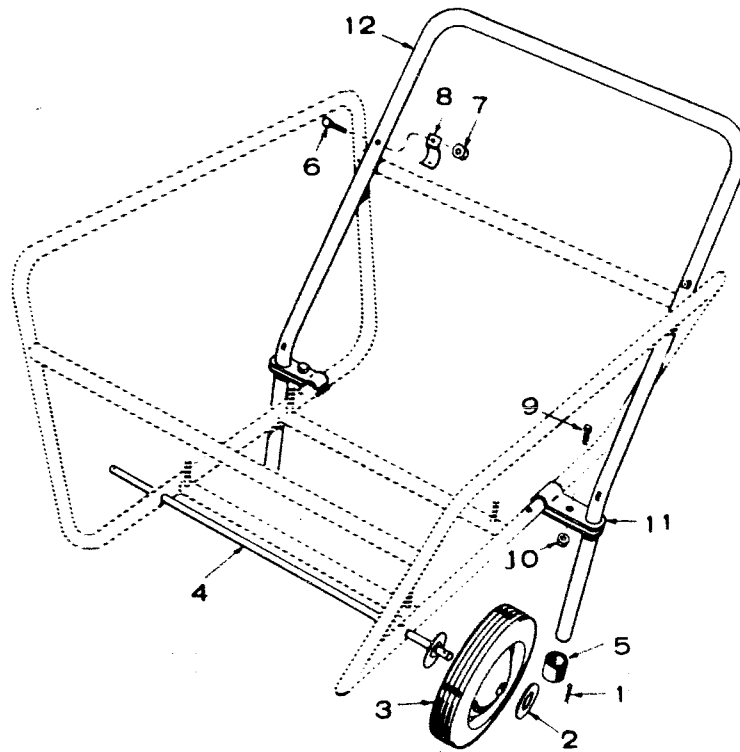

REF NO.	PART NUMBER	PART DESCRIPTION	QUANTITY USED									
			A	B	C	D	E	F	G	H	J	I
	410-0640	Dolly Package - Complete				1	1	1	1			
1	516-0042	Pin, Cotter				2	2	2	2			
2	526-0219	Washer, Flat (17/32" ID x 1" OD x 1/8" Thk)				6	6	6	6			
3	410-0618	Wheel, Dolly				2	2	2	2			
4	410-0658	Axle, Dolly				1	1	1	1			
5	403-0588	Tip, Handle				2	2	2	2			
6	800-0009	Screw, Cap - Hex Head (1/4-20 x 1-1/2")				2	2	2	2			
7	870-0212	Nut, Hex (1/4")				2	2	2	2			
8	331-0112	Clamp, Handle				2	2	2	2			
9	821-0016	Screw, Cap - Hex Head - Locking (5/16-18 x 3/4")				2	2	2	2			
10	870-0257	Nut, Hex (5/16")				2	2	2	2			
11	410-0634	Clamp, Frame				2	2	2	2			
12	410-0639	Handle, Dolly				1	1	1	1			

ENGINE AND CARRYING FRAME GROUP

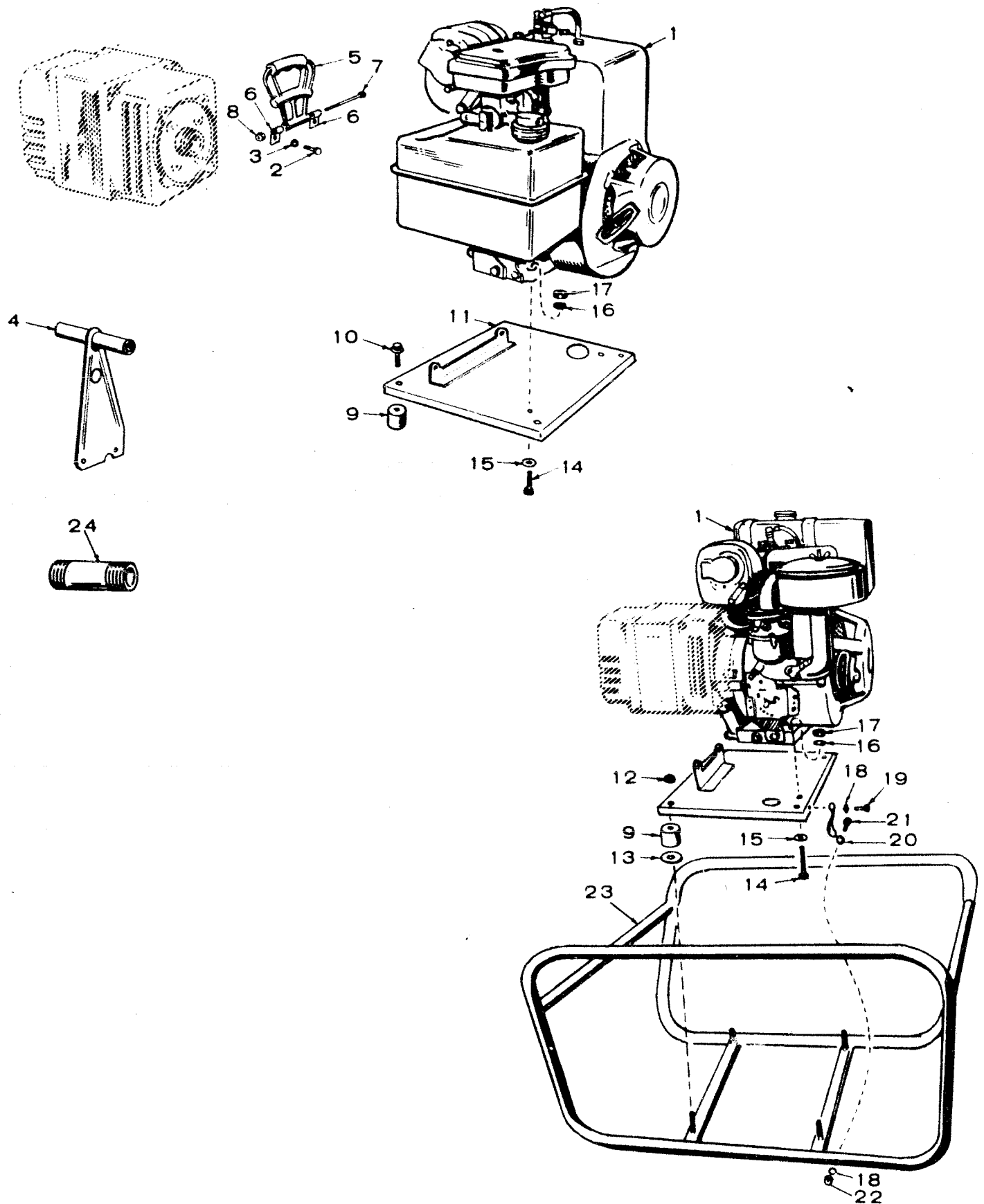

ENGINE AND CARRYING FRAME GROUP

REF NO.	PART NUMBER	PART DESCRIPTION	QUANTITY USED										
			A	B	C	D	E	F	G	H	J	K	
1	ENGINE (Refer to Manufacturer for Component Parts)												
	100-1167	3 Horsepower (Briggs & Stratton Model 80232 Spec 9673-01)	1										
	100-1168	4 Horsepower (Briggs & Stratton Model 100232 Spec 0492-01)		1									
	100-1159	5 Horsepower (Briggs & Stratton Model 130232 Spec 0545-01)			1								
	100-1160	8 Horsepower (Briggs & Stratton Model 190432 Spec 0793-01)				1							
	100-1161	10 Horsepower (Briggs & Stratton Model 243432 Spec 0678-01) (Cast Iron)					1						
	100-1164	13 Horsepower (Briggs & Stratton Model 302432 Spec 0142-01)						1					
	100-1450	10 Horsepower (Briggs & Stratton Model 251412) (Aluminum)								1			
2	800-0025	Screw, Cap - Hex Head (5/16-18 x 5/8")	2	2	2								
3	850-0045	Washer, Lock - Spring (5/16")	2	2	2								
4	403-1047	Handle, Carrying - PC Spec D, PD, PE Spec A and B	1	1	1								
5	403-1173	Handle, Carrying - PC Begin Spec E, PD, PE Begin Spec C	1	1	1								
6	403-1172	Hinge, Carrying Handle - PC Begin Spec E, PD, PE Begin Spec C	2	2	2								
7	800-0021	Screw, Cap - Hex Head (1/4-20 x 4-1/2") PC Begin Spec E, PD, PE Begin Spec C	1	1	1								
8	870-0065	Nut, Hex - Self Locking - PC Begin Spec E, PD, PE Begin Spec C	1	1	1								
9	402-0425	Dampener, Vibration	4	4	4								
9	402-0420	Dampener, Vibration				4							
9	402-0421	Dampener, Vibration					4	4	4				
10	821-0014	Screw, Cap - Hex Head Locking (5/16-18 x 1/2")	4	4	4								
11	403-1044	Base, Mounting	1	1	1								
11	403-1035	Base, Mounting				1							
11	403-1036	Base, Mounting					1	1					
11	403-1256	Base, Mounting								1			
12	870-0297	Nut, Hex - Self Locking (3/8-16)				4	4	4	4				
13	526-0123	Washer, Flat (25/64" ID x 1-1/4" OD x .598 Thk)				4	4	4	4				
14	800-0030	Screw, Cap - Hex Head (5/16-18 x 1-1/4")	2	2	2								
14	800-0051	Screw, Cap - Hex Head (3/8-16 x 1-1/4")				2	2	2	2				
15	526-0022	Washer, Flat (21/64" ID x 9/16 OD x 1/16" Thk)	2	2	2								
15	526-0013	Washer, Flat (25/64" ID x 1" OD x 1/16" Thk)				2	2	2	2				
16	850-0045	Washer, Lock - Spring (5/16")	2	2	2								
16	850-0050	Washer, Lock - Spring (3/8")				2	2	2	2				
17	862-0013	Nut, Hex (5/16-18)	2	2	2								
17	862-0003	Nut, Hex (3/8-16)				2	2	2	2				

ENGINE AND CARRYING FRAME GROUP

REF NO.	PART NUMBER	PART DESCRIPTION	QUANTITY USED										
			A	B	C	D	E	F	G	H	J	K	
18	856-0006	Washer, Lock - EIT (1/4")				2	2	2	2				
19	800-0003	Screw, Cap - Hex Head (1/4-20 x 1/2")				1	1	1	1				
20	337-0097	Strap, Ground				1	1	1	1				
21	800-0009	Screw, Cap - Hex Head (1/4-20 x 1-1/2")				1	1	1	1				
22	862-0001	Nut, Hex (1/4-20)				1	1	1	1				
23	403-1098	Frame, Carrying				1							
23	403-1097	Frame, Carrying					1	1	1				
24	505-0107	Nipple, Pipe - Exhaust (1 x 2")								1			

GENERATOR GROUP

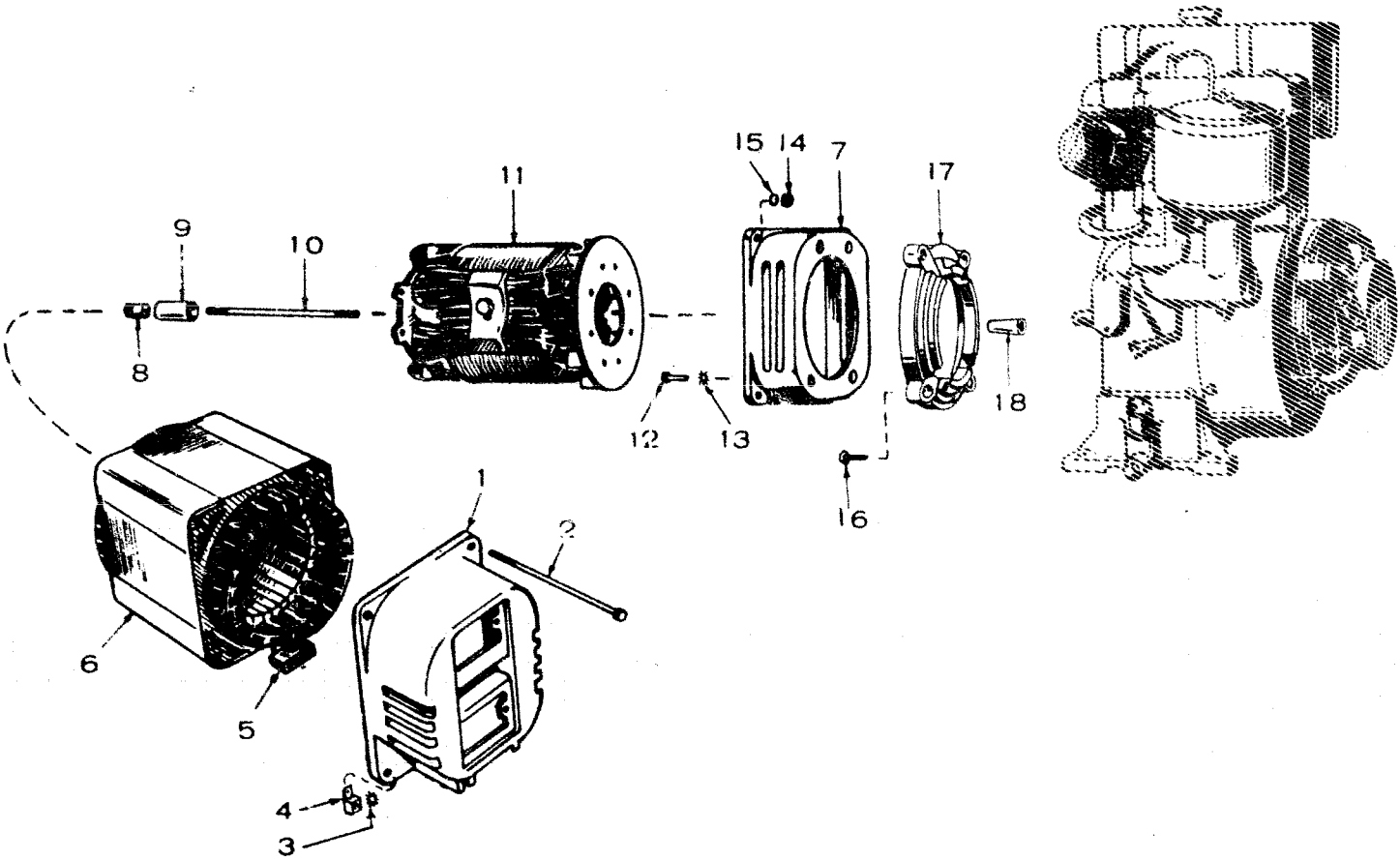

GENERATOR GROUP

REF NO.	PART NUMBER	PART DESCRIPTION	QUANTITY USED										
			A	B	C	D	E	F	G	H	J	K	
1		End Bell Assembly (See Separate Group)	1	1	1	1	1	1	1				
2	800-0017	Screw, Cap - Hex Head (1/4-20 x 3-1/2")	4										
2	800-0021	Screw, Cap - Hex Head (1/4-20 x 4-1/2")		4	4								
2	800-0187	Screw, Cap - Hex Head (1/4-20 x 5-1/2")				4							
2	800-0188	Screw, Cap - Hex Head (1/4-20 x 6-1/2")					4			4			
2	800-0189	Screw, Cap - Hex Head (1/4-20 x 8")						4					
3	856-0006	Washer, Lock - EIT (1/4")	1	1	1	1	1	1	1	1			
4	332-0142	Terminal, Lug - Solderless	1	1	1	1	1	1	1	1			
5	323-0849	Housing, Tab Connector (PC Spec B, PD, PE, PF, PG, PH Spec A and B)	1	1	1	1	1	1	1	1			
6	STATOR ASSEMBLY, WOUND												
	220-2392	100/200 Volt, 50 Hertz ▲	1										
	220-2393	100/200 Volt, 50 Hertz ▲		1	1								
	220-2394	100/200 Volt, 50 Hertz ▲				1							
	220-2395	100/200 Volt, 50 Hertz ▲					1						
	220-2396	100/200 Volt, 50 Hertz ▲						1					
	220-2554	100/200 Volt, 50 Hertz ●	1										
	220-2555	100/200 Volt, 50 Hertz ●		1	1								
	220-2556	100/200 Volt, 50 Hertz ●				1							
	220-2557	100/200 Volt, 50 Hertz ●					1			1			
	220-2558	100/200 Volt, 50 Hertz ●						1					
	220-2093	110/220 Volt, 50 Hertz ▲	1										
	220-2094	110/220 Volt, 50 Hertz ▲		1	1								
	220-2095	110/220 Volt, 50 Hertz ▲				1							
	220-2096	110/220 Volt, 50 Hertz ▲					1						
	220-2097	110/220 Volt, 50 Hertz ▲						1					
	220-2562	110/220 Volt, 50 Hertz ●	1										
	220-2563	110/220 Volt, 50 Hertz ●		1	1								
	220-2564	110/220 Volt, 50 Hertz ●				1							
	220-2565	110/220 Volt, 50 Hertz ●					1			1			
	220-2566	110/220 Volt, 50 Hertz ●						1					
	220-2323	120/240 Volt, 50 Hertz ▲	1										
	220-2324	120/240 Volt, 50 Hertz ▲		1	1								
	220-2325	120/240 Volt, 50 Hertz ▲				1							
	220-2326	120/240 Volt, 50 Hertz ▲					1						
	220-2327	120/240 Volt, 50 Hertz ▲						1					
	220-2570	120/240 Volt, 50 Hertz ●	1										
	220-3571	120/240 Volt, 50 Hertz ●		1	1								
	220-2572	120/240 Volt, 50 Hertz ●				1							
	220-2573	120/240 Volt, 50 Hertz ●					1			1			
	220-2574	120/240 Volt, 50 Hertz ●						1					
	220-1949	120 Volt and 120/240 Volt, 60 Hertz ▲	1										
	220-1950	120 Volt and 120/240 Volt, 60 Hertz ▲		1	1								
	220-1951	120/240 Volt, 60 Hertz ▲				1							
▲ -	These parts are applicable to PC Spec D and PD, PE, PF, PG, PH Spec A and B.												
● -	These parts are applicable to PC Begin Spec E and PD, PE, PF, PG, PH, PK Begin Spec C.												

GENERATOR GROUP

REF NO.	PART NUMBER	PART DESCRIPTION	QUANTITY USED									
			A	B	C	D	E	F	G	H	J	
	220-1952	120/240 Volt, 60 Hertz▲					1					
	220-1953	120/240 Volt, 60 Hertz▲						1				
	220-2472	120 Volt and 120/240 Volt, 60 Hertz●	1									
	220-2473	120 Volt and 120/240 Volt, 60 Hertz●		1	1							
	220-2474	120/240 Volt, 60 Hertz●				1						
	220-2475	120/240 Volt, 60 Hertz●					1		1			
	220-2476	120/240 Volt, 60 Hertz●						1				
7	231-0193	Adapter, Generator	1	1	1	1						
7	231-0195	Adapter, Generator					1	1	1			
8	870-0271	Nut, Internal Wrenching (5/16-18)	1	1	1	1	1	1	1			
9	202-0674	Sleeve, Shaft	1	1	1	1	1	1	1			
10	520-0806	Stud, Rotor Through (5/16 x 4-13/16")	1									
10	520-0807	Stud, Rotor Through (5/16 x 5-9/16")		1	1							
10	520-0825	Stud, Rotor Through (5/16 x 7-9/16")				1	1		1			
10	520-0826	Stud, Rotor Through (5/16 x 9-1/16")						1				
11	201-2020	Rotor Assembly	1									
11	201-2021	Rotor Assembly		1	1							
11	201-2022	Rotor Assembly				1						
11	201-2023	Rotor Assembly					1		1			
11	201-2024	Rotor Assembly						1				
12	801-0027	Screw, Cap - Hex Head (5/16-24 x 7/8")	4	4	4	4						
12	800-0049	Screw, Cap - Hex Head (3/8-16 x 7/8")					4	4	4			
13	854-0017	Washer, Lock - IT (5/16")	4	4	4	4						
13	854-0021	Washer, Lock - IT (3/8")					4	4	4			
14	862-0001	Nut, Machine - Hex (1/4-20)	4	4	4	4	4	4	4			
15	850-0040	Washer, Lock - Spring (1/4")	4	4	4	4	4	4	4			
16	814-0226	Screw, Flat Head					4	4	4			
17	231-0173	Adapter, Engine					1	1	1			
18	202-0699	Adapter, Shaft					1	1	1			
▲ -	These parts are applicable to PC Spec D and PD, PE, PF, PG, PH Spec A and B.											
● -	These parts are applicable to PC Begin Spec E and PD, PE, PF, PG, PH, PK Begin Spec C.											

END BELL GROUP
PC—Begin Spec E
PD, PE, PF, PG, PH, PK—Begin Spec C
NOTE: See separate Group for earlier Specs.

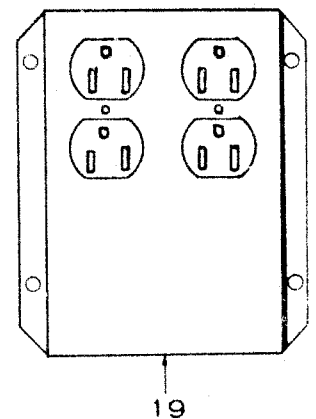
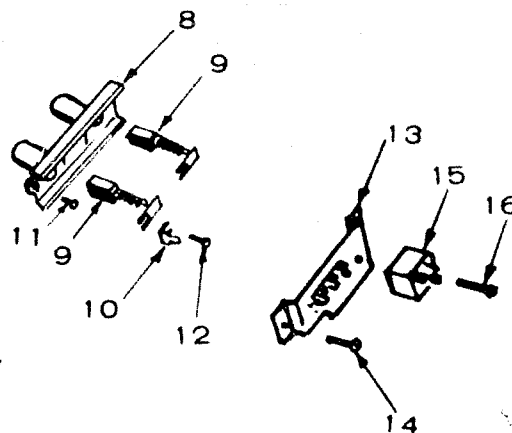
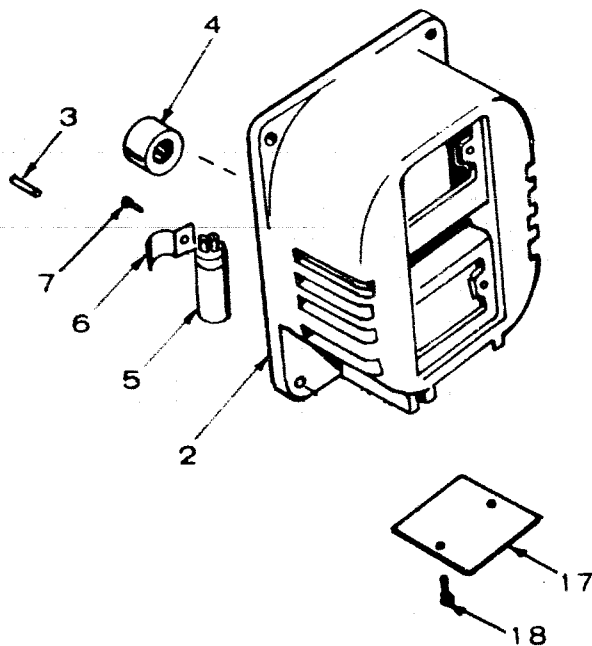
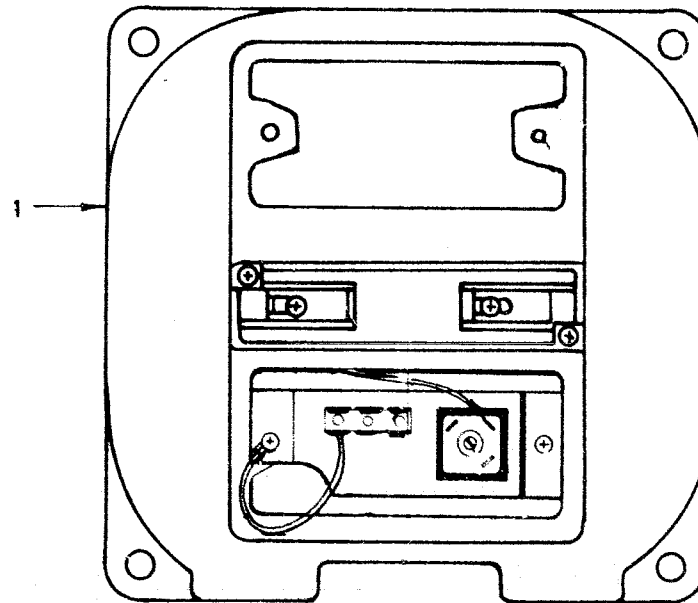

END BELL GROUP
PC—Begin Spec E
PD, PE, PF, PG, PH, PK—Begin Spec C
NOTE: See separate Group for earlier Specs.

REF NO.	PART NUMBER	PART DESCRIPTION	QUANTITY USED									
			A	B	C	D	E	F	G	H	J	I
1	211-0266	Bell Assembly, End (Includes Parts Marked *)	1	1	1	1	1	1	1			
2	211-0238	Bell Only, End*	1	1	1	1	1	1	1			
3	516-0182	Pin, Locating - End Bell*	4	4	4	4	4	4	4			
4	510-0107	Bearing, Roller*	1	1	1	1	1	1	1			
5	356-0056	Capacitor*	1	1	1	1	1	1	1			
6	312-0194	Bracket, Capacitor Mounting*	1	1	1	1	1	1	1			
7	815-0395	Screw, Tapping - Pan Head (#6 x 3/8")*	1	1	1	1	1	1	1			
8	212-1249	Guide, Brush*	1	1	1	1	1	1	1			
9	214-0099	Brush, Alternator*	2	2	2	2	2	2	2			
10	332-1564	Terminal Tab*	1	1	1	1	1	1	1			
11	815-0395	Screw, Tapping - Pan Head (#6 x 3/8")*	2	2	2	2	2	2	2			
12	815-0388	Screw, Tapping - Pan Head (#6 x 1/2")*	2	2	2	2	2	2	2			
13	232-2697	Bracket and Terminal Assembly*	1	1	1	1	1	1	1			
14	815-0395	Screw, Tapping - Pan Head (#6 x 3/8")*	2	2	2	2	2	2	2			
15	305-0548	Rectifier, Bridge*	1	1	1	1	1	1	1			
16	815-0198	Screw, Machine - Round Head (#8-32 x 5/8")*	1	1	1	1	1	1	1			
17	234-0526	Cover, Protection	1	1	1	1	1	1	1			
18	815-0340	Screw, Cap - Hex Head - Tapping (#10 x 3/8")	2	2	2	2	2	2	2			
19		Receptacle Box Assembly - See Separate Group	1	1	1	1	1	1	1			

END BELL RECEPTACLE BOX GROUP (60 HERTZ)

PC—Begin Spec E
PD, PE, PF, PG, PH, PK—Begin Spec C

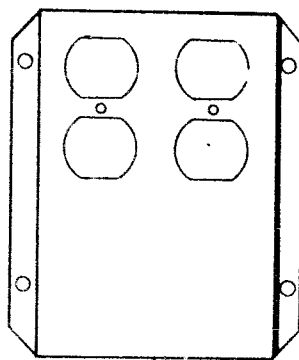
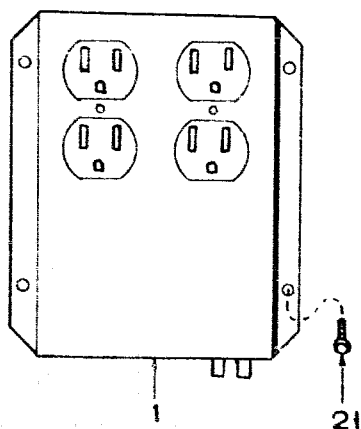

2

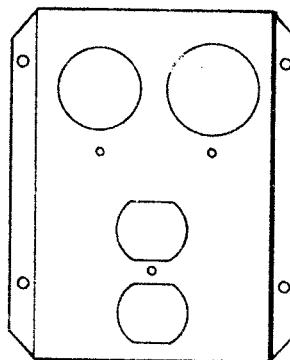

3

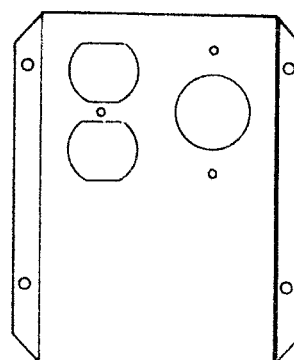

4

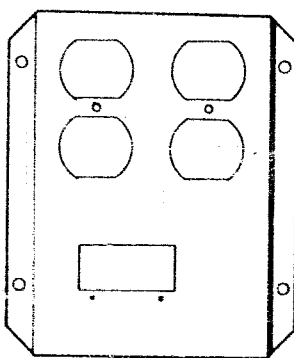

5

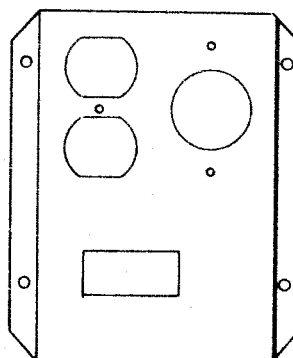

6

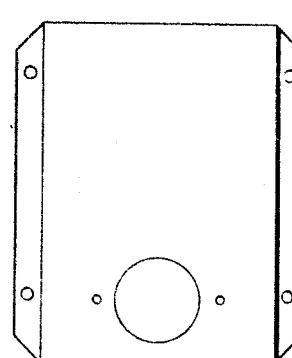

7

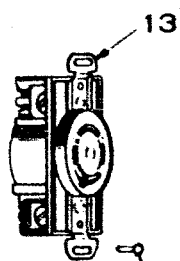

16

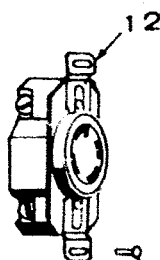

16

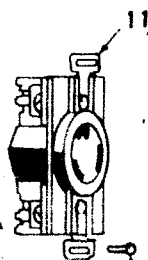

16

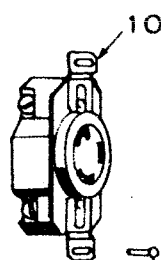

16



17

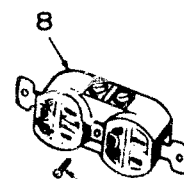

16

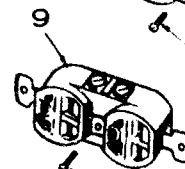

16

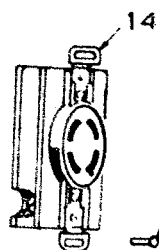

16

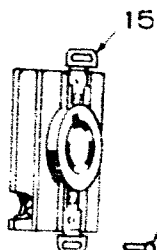

16

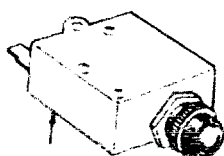

16



16



16

RECEPTACLE BOX GROUP (60 HERTZ)

PC Begin Spec E

PD, PE, PF, PG, PH, PK Begin Spec C

REF NO.	PART NUMBER	PART DESCRIPTION	QUANTITY USED									
			A	B	C	D	E	F	G	H	J	
1	BOX ASSEMBLY, RECEPTACLE											
	323-0969	With two 120 Volt Duplex Receptacles (Includes Parts Marked a)	1	1	1							
	323-0970	With two 120 Volt Duplex Receptacles and Voltmeter (Includes Parts Marked b)	1	1	1							
	323-0953	With two 120 Volt Duplex Receptacles, Voltmeter and two 15 amp Circuit Breakers (Includes Parts Marked c)	1	1	1							
	323-0923	With two 120 Volt Duplex Receptacles and two 15 Amp Circuit Breakers (Includes Parts Marked d)	1	1	1							
	323-0967	With one 120 Volt and one 240 Volt Duplex Receptacles (Includes Parts Marked e)				1	1	1	1			
	323-0924	With one 120 Volt and one 240 Volt Duplex Receptacles and three 15 amp Circuit Breakers (Includes Parts Marked f)				1	1	1	1			
	323-0954	With one 120 Volt and one 240 Volt Duplex Receptacles, Voltmeter, and three 15 amp Circuit Breakers (Includes Parts Marked g)				1	1	1	1			
	323-0968	With one 120 Volt and one 240 Volt Duplex Receptacles and Voltmeter (Includes Parts Marked h)				1	1	1	1			
	323-0975	With one 120 Volt Duplex and one 20 amp, 120/240 Volt, 3 Wire Twistlock Receptacles, one 15 amp and two 25 amp Circuit Breakers (Includes Parts Marked j)				1	1	1	1			
	323-0976	With one 120 Volt Duplex and one 20 amp, 120/240 Volt, 3 Wire Twistlock Receptacles, Voltmeter, one 15 amp and two 25 amp Circuit Breakers (Includes Parts Marked k)				1	1	1	1			
	323-0973	With one 120 Volt Duplex and one 20 amp, 120/240 Volt, 3 Wire Twistlock Receptacles (Includes Parts Marked l)				1	1	1	1			
	323-0972	With one 120 Volt Duplex and one 20 amp, 120/240 Volt, 3 Wire Twistlock Receptacles and Voltmeter (Includes Parts Marked m)				1	1	1	1			
	323-0965	With one 120 Volt Duplex and one 20 amp, 120/240 Volt, 4 Wire, Twistlock Receptacles (Includes Parts Marked n)				1	1	1	1			
	323-0961	With one 120 Volt Duplex and one 20 amp, 120/240 Volt, 4 Wire Twistlock Receptacles and Voltmeter (Includes Parts Marked p)				1	1	1	1			
	323-0960	With one 120 Volt Duplex and one 20 amp, 120/240 Volt, 4 Wire Twistlock Receptacles, Voltmeter, one 15 amp and two 20 amp Circuit Breakers (Includes Parts Marked q)				1	1	1	1			

RECEPTACLE BOX GROUP (60 HERTZ)

PC Begin Spec E

PD, PE, PF, PG, PH, PK Begin Spec C

REF NO.	PART NUMBER	PART DESCRIPTION	QUANTITY USED									
			A	B	C	D	E	F	G	H	J	
	323-0951	With one 120 Volt Duplex and one 30 Amp, 120/240 Volt, 4 Wire Twistlock Receptacles, one 15 Amp and two 25 Amp Circuit Breakers (Includes Parts Marked r)				1	1	1	1			
	323-0955	With one 120 Volt Duplex and one 30 Amp, 120/240 Volt, 4 Wire Twistlock Receptacles, Voltmeter, one 15 Amp and two 30 Amp Circuit Breakers (Includes Parts Marked s)				1	1	1	1			
	323-0956	With one 120 Volt Duplex and one 30 Amp, 120/240 Volt, 4 Wire Twistlock Receptacles, Voltmeter, one 15 Amp and two 25 Amp Circuit Breakers (Includes Parts Marked t)				1	1	1	1			
	323-0962	With one 120 Volt Duplex and one 30 Amp, 120/240 Volt, 4 Wire Twistlock Receptacles and Voltmeter (Includes Parts Marked u)				1	1	1	1			
	323-0964	With one 120 Volt Duplex and one 30 Amp, 120/240 Volt, 4 Wire Twistlock Receptacles (Includes Parts Marked v)				1	1	1	1			
	323-0925	With one 120 Volt Duplex, one 20 Amp, 240 Volt, 3 Wire Twistlock and one 30 Amp, 120 Volt, 3 Wire Twistlock Receptacles, one 15 Amp, one 30 Amp and two 20 Amp Circuit Breakers (Includes Parts Marked w)				1	1	1	1			
	323-0959	With one 20 Amp, 240 Volt Twistlock Receptacle (Includes Parts Marked x)				1	1	1	1			
	BOX, RECEPTACLE											
2	301-3916	With Holes for two Duplex Receptacles and two Circuit Breakers a d f e		As	Required							
3	301-3915	With Holes for one Duplex Receptacle, two Single Receptacles (1.61" Diameter and 1.75" Diameter and Four Circuit Breakers w		As	Required							
4	301-3824	With Holes for one Duplex Receptacle, one Single Receptacle (1.75" Diameter) and three Circuit Breakers n r v		As	Required							
4	301-3987	With Holes for one Duplex Receptacle, one Single Receptacle (1.437" Diameter) and three Circuit Breakers j l		As	Required							
5	301-3872	With Holes for two Duplex Receptacles, two Circuit Breakers and Voltmeter b c g h		As	Required							
6	301-3873	With Holes for one Duplex Receptacle, one Single Receptacle (1.75" Diameter) three Circuit Breakers and Voltmeter p q s t u		As	Required							

RECEPTACLE BOX GROUP (60 HERTZ.)

PC Begin Spec E

PD, PE, PF, PG, PH, PK Begin Spec C

REF NO.	PART NUMBER	PART DESCRIPTION	QUANTITY USED									
			A	B	C	D	E	F	G	H	J	
6	301-3988	With Holes for one Duplex Receptacle, one Single Receptacle (1.437" Diameter), three Circuit Breakers and Voltmeter k m										
7	301-3875	With Hole for Single Receptacle (1.625" Diameter) x										
	RECEPTACLE,	OUTPUT										
8	323-0383	Duplex (120 Volt) Parallel Blades - a b c d e f g h j k l m n p q r s t u v w										
9	323-0213	Duplex (240 Volt) Tandem Blades e f g h										
10	323-0854	Twistlock (30 Amp, 120 Volt, 3 Wire) w										
11	323-0855	Twistlock (20 Amp, 240 Volt, 3 Wire) w										
12	323-0943	Twistlock (30 Amp, 120/240 Volt, 4 Wire) r s t u v										
13	323-0856	Twistlock (20 Amp, 120/240 Volt, 4 Wire) n p q										
14	323-0091	Twistlock (20 Amp, 240 Volt, 4 Wire) x										
15	323-0971	Twistlock (20 Amp, 120/240 Volt, 3 Wire) j k l m										
16	812-0061	Screw, Machine - Round Head (#6-32 x 3/8") a b c d e f g h j k l m n p q r s t u v w x										
17	323-0869	Strap, Ground a b c d e f g h j k l m n p q r s t u v w x										
18	BREAKER, CIRCUIT											
	320-0540	15 Ampere c d f g j k q r t u v										
	320-0541	20 Ampere q v										
	320-0542	25 Ampere j k r t										
	320-0543	30 Ampere s w										
19	302-1031	Voltmeter, AC b c g h k m p q s t u										
20	332-0556	Connector, Faston a b h l m n p u v										
21	815-0340	Screw, Cap - Hex Head (#10-32 x 3/8")	4	4	4	4	4	4	4			

NOTE: Several variations of the receptacle box are listed in this group. The generators can be connected in parallel or series to get single or dual voltage operation. Throughout this group, alphabetical letters are used to identify components of the various receptacle box assemblies. See individual box assemblies listed for code letter on component parts.

END BELL GROUP

PC-Spec D

PD, PE, PF, PG, PH-Spec A and B

NOTE: See separate groups for later specs.

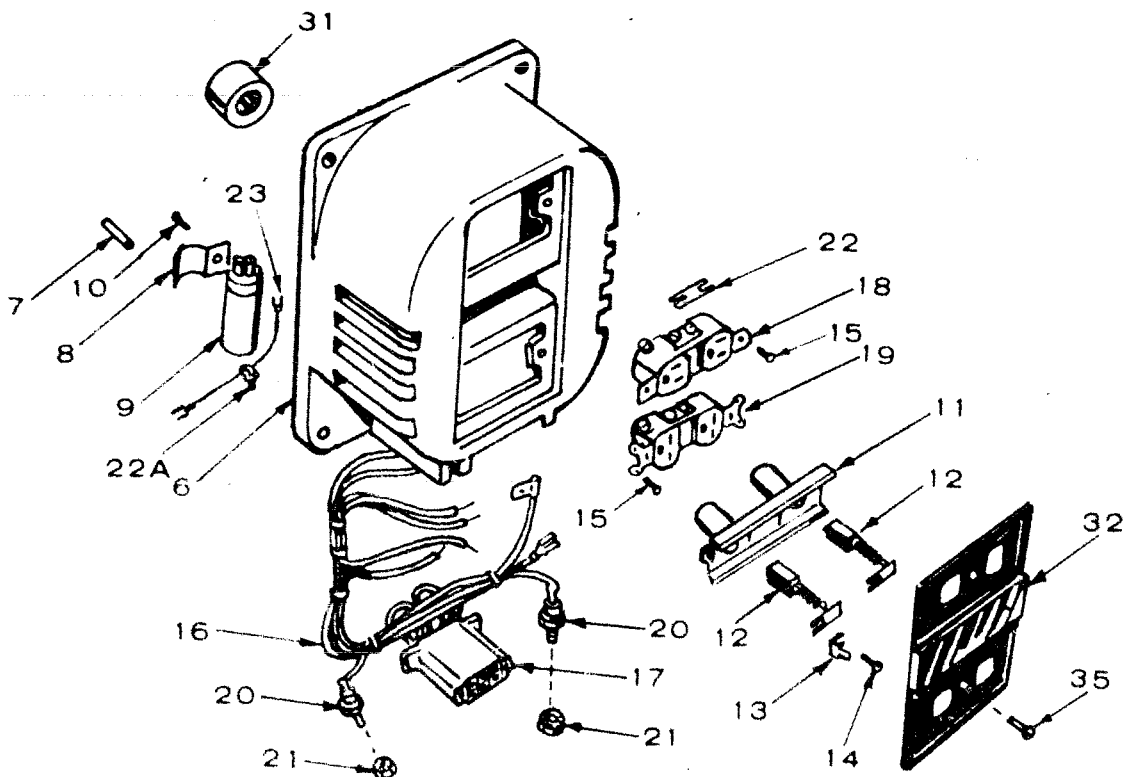
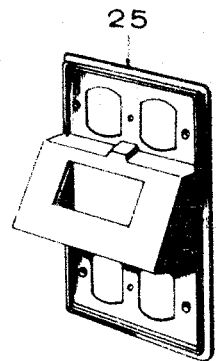
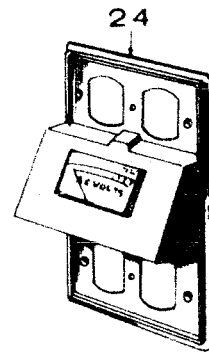
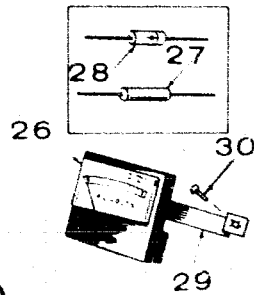
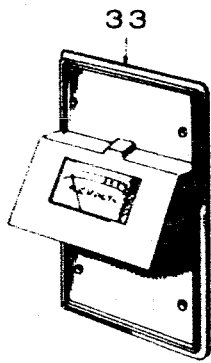
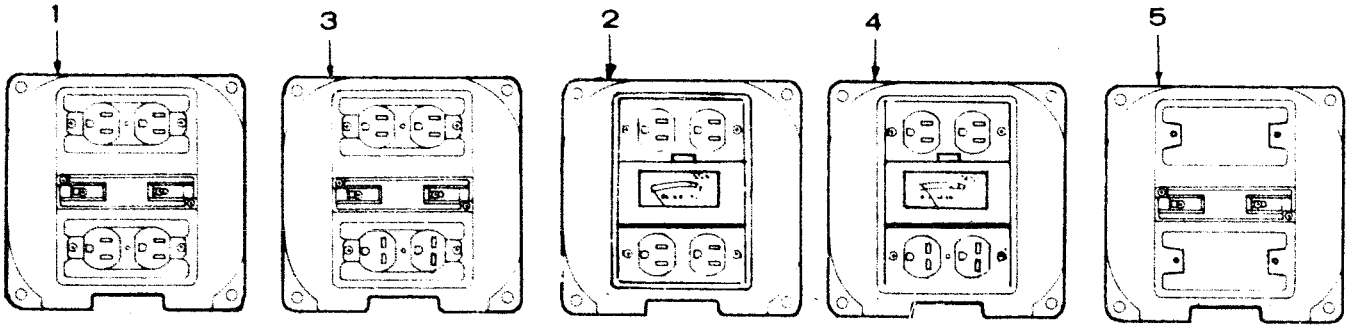

END BELL GROUP
PC-Spec D
PD, PE, PF, PG, PH-Spec A and B
NOTE: See separate groups for later specs.

REF NO.	PART NUMBER	PART DESCRIPTION	QUANTITY USED									
			A	B	C	D	E	F	G	H	J	
30	815-0395	Screw, Pan Head (#6-32 x 3/8") □	2	2	2	2	2	2				
31	510-0107	Bearing, Roller *Δ†£•	1	1	1	1	1	1				
32	232-2468	Cover, End Bell - Receptacle (60 Hertz Generator Sets)	1	1	1	1	1	1				
33	232-2449	Cover Assembly, End Bell - Generator Sets Without Receptacles in End Bell (Includes Parts Marked Ø)	1	1	1	1	1	1				
34	232-2440	Cover Only - End Bell - Generator Sets Without Receptacles in End Bell Ø	1	1	1	1	1	1				
35	815-0396	Screw, Machine - Fillister Head (#6-32 x 1/2")	2	2	2	2	2	2				
<div>* - Included in 211-0243 End Bell Assembly.</div> <div>Δ - Included in 211-0257 End Bell Assembly.</div> <div>† - Included in 211-0247 End Bell Assembly.</div> <div>£ - Included in 211-0258 End Bell Assembly.</div> <div>• - Included in 211-0245 End Bell Assembly.</div> <div># - Included in 338-0716 Wiring Harness Assembly.</div> <div>‡ - Included in 338-0717 Wiring Harness Assembly.</div> <div>§ - Included in 338-0727 Wiring Harness Assembly.</div> <div>□ - Included in 232-2448 End Bell Cover Assembly.</div> <div>Ø - Included in 232-2449 End Bell Cover Assembly.</div>												

PRINTED CIRCUIT BOARD (300-1185)

IDLE-MATIC CONTROL

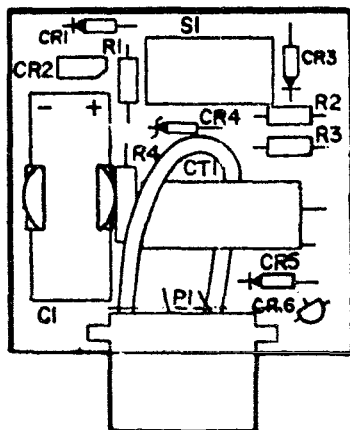
[illegible]

SIDE MOUNTED RECEPTACLE BOX GROUP
 Standard for 50 Hertz Sets and optional for 60 Hertz Sets.
 PC-Begin Spec E; PD, PE, PF, PG, PH, PK-Begin Spec C.

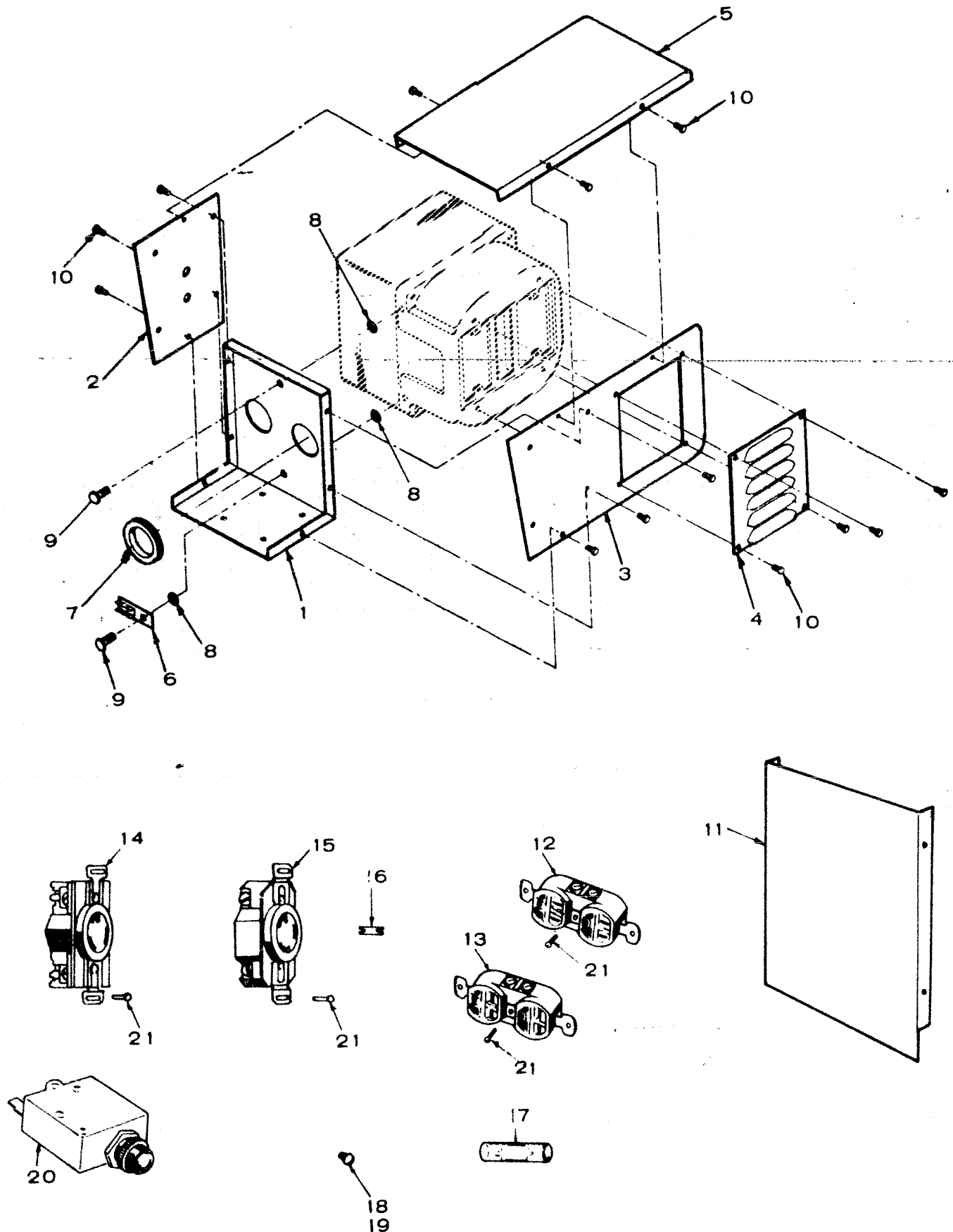

SIDE MOUNTED RECEPTACLE BOX GROUP
Standard for 50 Hertz Sets and optional for 60 Hertz Sets.
PC-Begin Spec E; PD, PE, PF, PG, PH, PK-Begin Spec C.

REF NO.	PART NUMBER	PART DESCRIPTION	QUANTITY USED									
			A	B	C	D	E	F	G	H	J	
1	301-4072	Frame, Control	1	1	1	1	1	1				
2	301-4073	Panel, Control (Front)	1	1	1	1	1	1				
3	301-4074	Panel, Control (Rear)	1	1	1	1	1	1				
4	301-4079	Panel, Louver (Rear)	1	1	1	1	1	1				
5	COVER, CONTROL (TOP)											
	301-4080	Left Side Mount	1	1	1	1	1	1				
	301-4081	Right Side Mount	1	1	1	1	1	1				
6	232-2636	Bracket and Terminal Assembly	1	1	1	1	1	1				
7	508-0051	Grommet, Rubber	1	1	1	1	1	1				
8	854-0020	Washer, Lock - IT (3/8")	3	3	3	3	3	3				
9	815-0384	Screw, Cap - Hex Head (3/8-16 x 3/4")	2	2	2	2	2	2				
10	815-0340	Screw, Cap - Hex Head (#10-32 x 3/8")	13	13	13	13	13	13				
11	PANEL, RECEPTACLE											
	301-4077	Blank - 50 Hertz Sets	1	1	1	1						
	301-4200	Holes for Circuit Breakers only - 50 Hertz Sets					1	1				
	301-4075	Holes for 2 Duplex Receptacles, 4 Circuit Breakers and Battery Charger - 60 Hertz Sets	1	1	1	1	1	1				
	301-4076	Holes for 2 Twistlock Receptacles, one Duplex Receptacles, 4 Circuit Breakers and Battery Charger - 60 Hertz Sets	1	1	1	1	1	1				
12	323-0383	Receptacle, Duplex (120 Volt) Parallel Blades - 60 Hertz Sets		As	Required							
13	323-0213	Receptacle, Duplex (240 Volt) Tandem Blades - 60 Hertz Sets		As	Required							
14	323-0855	Receptacle - Twistlock (200 Amp, 240 Volt) - 60 Hertz Sets		As	Required							
15	323-0854	Receptacle - Twistlock (30 Amp, 125 Volt) - 60 Hertz Sets		As	Required							
16	323-0819	Strap, Ground - Receptacle - 60 Hertz Sets		As	Required							
17	332-1556	Connector, Faston - 60 Hertz Sets		As	Required							
18	517-0132	Plug, Hole (7/16")		As	Required							
19	517-0135	Plug, Hole (5/8")		As	Required							
20	BREAKER, CIRCUIT											
	320-0540	15 Ampere		As	Required							
	320-0541	20 Ampere		As	Required							
	320-0542	25 Ampere		As	Required							
	320-0543	30 Ampere		As	Required							
21	812-0061	Screw, Machine - Round Head (#6-32 x 3/8")		As	Required							

RECEPTACLE BOX ASSEMBLY GROUP—REMOTE (Optional) PC-Spec D; PD, PE, PF, PG, PH-Spec A and B

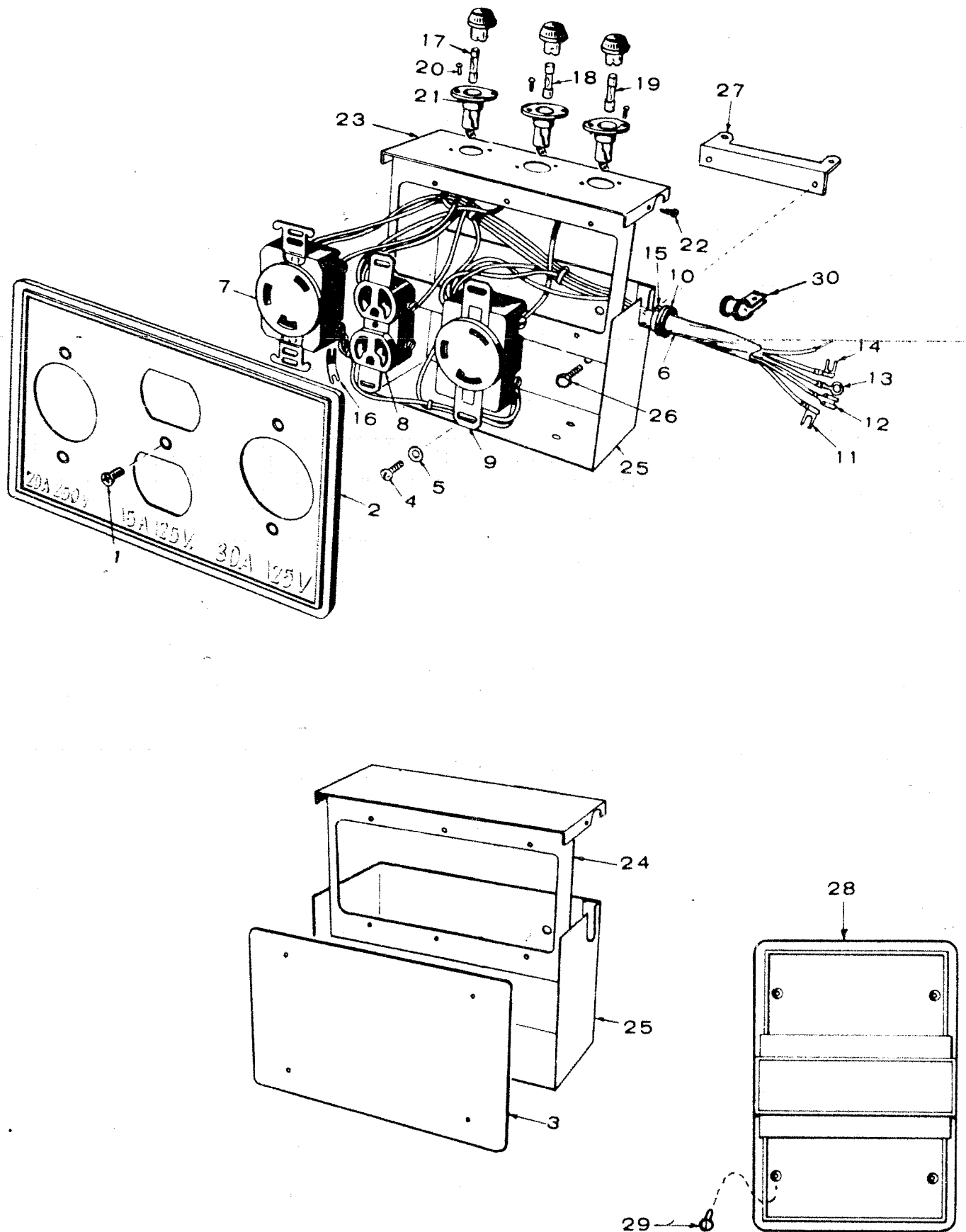

RECEPTACLE BOX ASSEMBLY GROUP—REMOTE (Optional)
PC-Spec D; PD, PE, PF, PG, PH-Spec A and B

EF O.	PART NUMBER	PART DESCRIPTION	QUANTITY USED										
			A	B	C	D	E	F	G	H	J	K	
	BOX ASSEMBLY, RECEPTACLE (60 Hertz Sets)												
	300-1094	With Fuses (Includes Parts Marked £)				1	1	1	1				
	300-1095	Without Fuses (Includes Parts Marked *)				1	1	1	1				
1	815-0396	Screw, Fillister Head (#6-32 x 1-1/2") £*				5	5	5	5				
1	815-0396	Screw, Fillister Head (#6-32 x 1-1/2") - 50 Hertz Sets				4	4	4	4				
2	301-3676	Cover, Receptacle £*				1	1	1	1				
3	301-3743	Cover, Box - 50 Hertz Sets				1	1	1	1				
4	808-0022	Screw, Machine - Round Head Tapping (#8 x 3/8") £*				6	6	6	6				
5	526-0048	Washer, Flat - Brass (.172 ID x 3/8 OD x 1/32" Thk) £*				6	6	6	6				
6	HARNESS, WIRING												
	338-0734	60 Hertz Sets With Fuses (Includes Parts Marked •) £				1	1	1	1				
	338-0733	60 Hertz Sets Without Fuses (Includes Parts Marked Δ)*				1	1	1	1				
	338-0767	50 Hertz Sets (Includes Parts Marked #)				1	1	1	1				
7	323-0873	Receptacle, Twistlock (20 Amp, 240 Volt) •Δ				1	1	1	1				
8	323-0872	Receptacle, Twistlock (30 Amp, 120 Volt) •Δ				1	1	1	1				
9	323-0383	Receptacle, Duplex (15 Amp, 120 Volt) •Δ				1	1	1	1				
10	508-0071	Grommet, Rubber •Δ#				1	1	1	1				
11	332-1563	Terminal, Flag (Right) •Δ				4	4	4	4				
12	332-1497	Terminal, Faston •Δ#				4	4	4	4				
13	332-0147	Terminal, Ring •Δ				1	1	1	1				
13	332-0325	Terminal, Ring #				1	1	1	1				
14	332-1562	Terminal, Flag - Left •Δ				2	2	2	2				
15	332-0941	Tie, Cable (7-1/4") •Δ#				1	1	1	1				
15	332-0942	Tie, Cable (3-1/2") •Δ				4	4	4	4				
16	323-0869	Strap, Ground •Δ				1	1	1	1				
17	321-0200	Fuse, Cartridge (20 Amp) £				1	1	1	1				
18	321-0199	Fuse, Cartridge (15 Amp) £				1	1	1	1				
19	321-0201	Fuse, Cartridge (30 Amp) £				1	1	1	1				
20	808-0022	Screw, Machine - Round Head Tapping (#8 x 3/8") £				6	6	6	6				
21	321-0198	Holder, Fuse £				3	3	3	3				
22	815-0395	Screw, Machine - Pan Head (#6 x 3/8") £				3	3	3	3				
23	301-3648	Bracket, Receptacle (Sets With Fuses) £				1	1	1	1				
24	301-3672	Bracket, Receptacle (50 and 60 Hertz Sets Without Fuses)*				1	1	1	1				
25	301-3649	Box, Receptacle (50 and 60 Hertz Sets) £*				1	1	1	1				
26	821-0009	Screw, Cap - Hex Head (1/4-20 x 3/8") (50 and 60 Hertz Sets) £*				4	4	4	4				
27	323-0876	Bracket, Box Mounting (50 and 60 Hertz Sets) £*				2	2	2	2				
28	232-2433	Cover, End Bell (50 and 60 Hertz Sets) £*				1	1	1	1				

RECEPTACLE BOX ASSEMBLY GROUP—REMOTE (Optional)

PC-Spec D; PD, PE, PF, PG, PH-Spec A and B

REF NO.	PART NUMBER	PART DESCRIPTION	QUANTITY USED									
			A	B	C	D	E	F	G	H	J	
29	815-0397	Screw, Flat Head Cross Recessed										
		(#6 x 1/2") (50 and 60 Hertz Sets) £*				4	4	4	4			
30	332-1554	Clamp, Harness (50 and 60 Hertz Sets) £*				1	1	1	1			

BATTERY CHARGER AND RUNNING LIGHT GROUP (OPTIONAL)

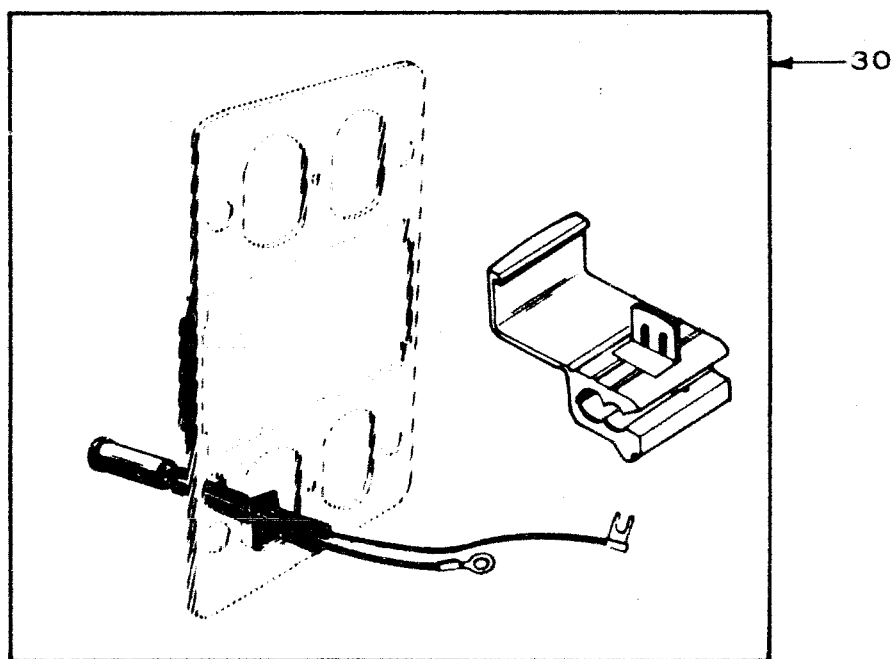
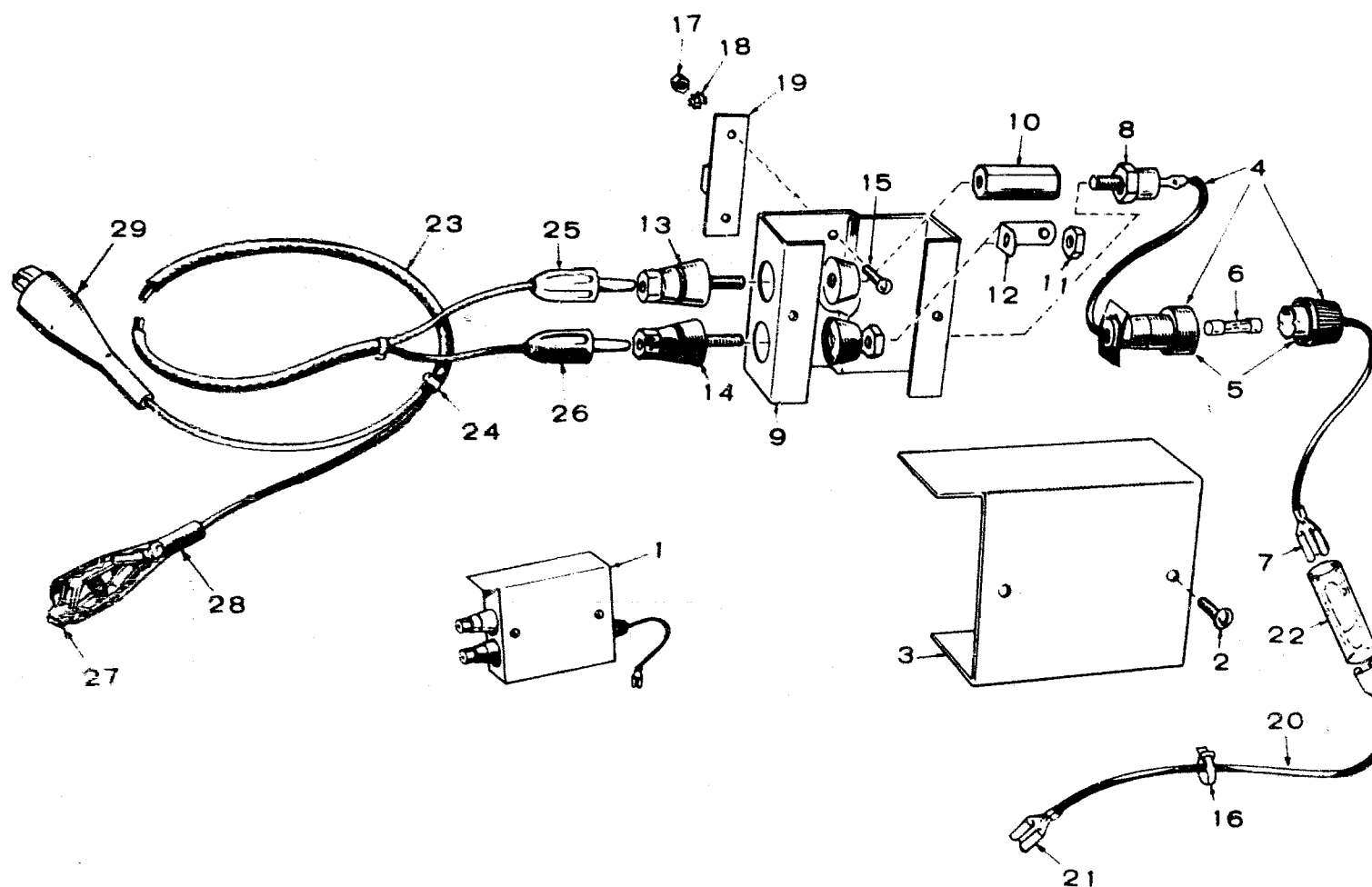

BATTERY CHARGER AND RUNNING LIGHT GROUP—OPTIONAL

NOTE: Some parts in this group do not apply to PC Begin Spec E and all other models Begin Spec C with the side mounted receptacle box.

REF NO.	PART NUMBER	PART DESCRIPTION	QUANTITY USED									
			A	B	C	D	E	F	G	H	J	
	305-0540	Charger Package, Battery - Complete with Mounting Hardware (Includes Parts Marked £)	1	1	1	1	1	1	1			
1	305-0527	Charger, Battery (Includes Parts Marked *) £	1	1	1	1	1	1	1			
2	815-0048	Screw, Machine - Round Head (#10-32 x 3/8")*	2	2	2	2	2	2	2			
3	232-2436	Cover, Charger*	1	1	1	1	1	1	1			
4	358-0059	Diode and Fuse Holder Assembly (Includes Parts Marked Δ)	1	1	1	1	1	1	1			
5	321-0203	Holder Assembly, Fuse (Includes Fuse) Δ	1	1	1	1	1	1	1			
6	321-0127	Fuse, Cartridge (15 Amp) Δ	1	1	1	1	1	1	1			
7	332-1497	Terminal, Lug - Faston Δ	1	1	1	1	1	1	1			
8	358-0016	Rectifier, Diode Δ	1	1	1	1	1	1	1			
9	232-2437	Bracket, Battery Charger Terminals*	1	1	1	1	1	1	1			
10	232-2438	Spacer, Threaded*	1	1	1	1	1	1	1			
11	870-0053	Nut, Hex (#10-32)*	2	2	2	2	2	2	2			
12	332-1575	Strip, Terminal*	1	1	1	1	1	1	1			
13	332-0785	Post, Binding - Red*	1	1	1	1	1	1	1			
14	332-0784	Post, Binding - Black*	1	1	1	1	1	1	1			
15	815-0333	Screw, Machine - Round Head (#10 x 1/2")*	2	2	2	2	2	2	2			
16	332-0942	Tie, Cable £	1	1	1	1	1	1	1			
17	870-0053	Nut, Hex (#10-32) £	2	2	2	2	2	2	2			
18	853-0008	Washer, Lock - ET £	2	2	2	2	2	2	2			
19	191-1074	Bracket, Mounting £	1	1	1	1	1	1	1			
20	336-2269	Lead Assembly (Includes Terminals) £	1	1	1	1	1	1	1			
21	332-1497	Terminal, Lug - Faston £	2	2	2	2	2	2	2			
22	332-0556	Connector, Splice - Faston	1	1	1	1	1	1	1			
23	305-0537	Cable Assembly (Includes Parts Marked †)	1	1	1	1	1	1	1			
24	332-0942	Tie, Cable †	2	2	2	2	2	2	2			
25	323-0888	Plug, Banana †	1	1	1	1	1	1	1			
26	323-0889	Plug, Banana †	1	1	1	1	1	1	1			
27	332-1446	Clip, Battery †	2	2	2	2	2	2	2			
28	332-1448	Insulator, Sleeve - Black †	1	1	1	1	1	1	1			
29	332-1447	Insulator, Sleeve - Red †	1	1	1	1	1	1	1			
30	322-0159	Light Package, Running	1	1	1	1	1	1	1			

£ - Included in 305-0540 Charger Package.

* - Included in 305-0527 Battery Charger.

Δ - Included in 358-0059 Diode and Fuse Holder Assembly.

† - Included in 305-0537 Cable Assembly.

£ - Included in 305-0540 Charger Package.

* - Included in 305-0527 Battery Charger.

Δ - Included in 358-0059 Diode and Fuse Holder Assembly.

† - Included in 305-0537 Cable Assembly.

IDLE-MATIC CONTROL (Optional)

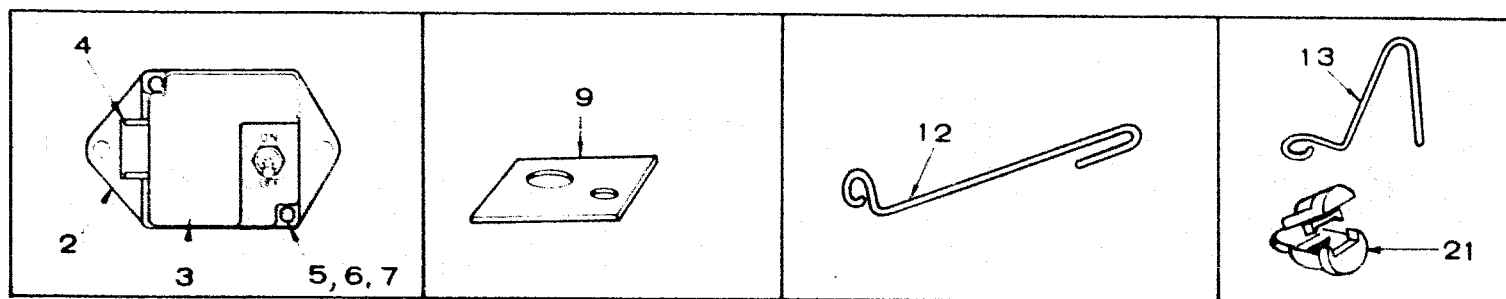
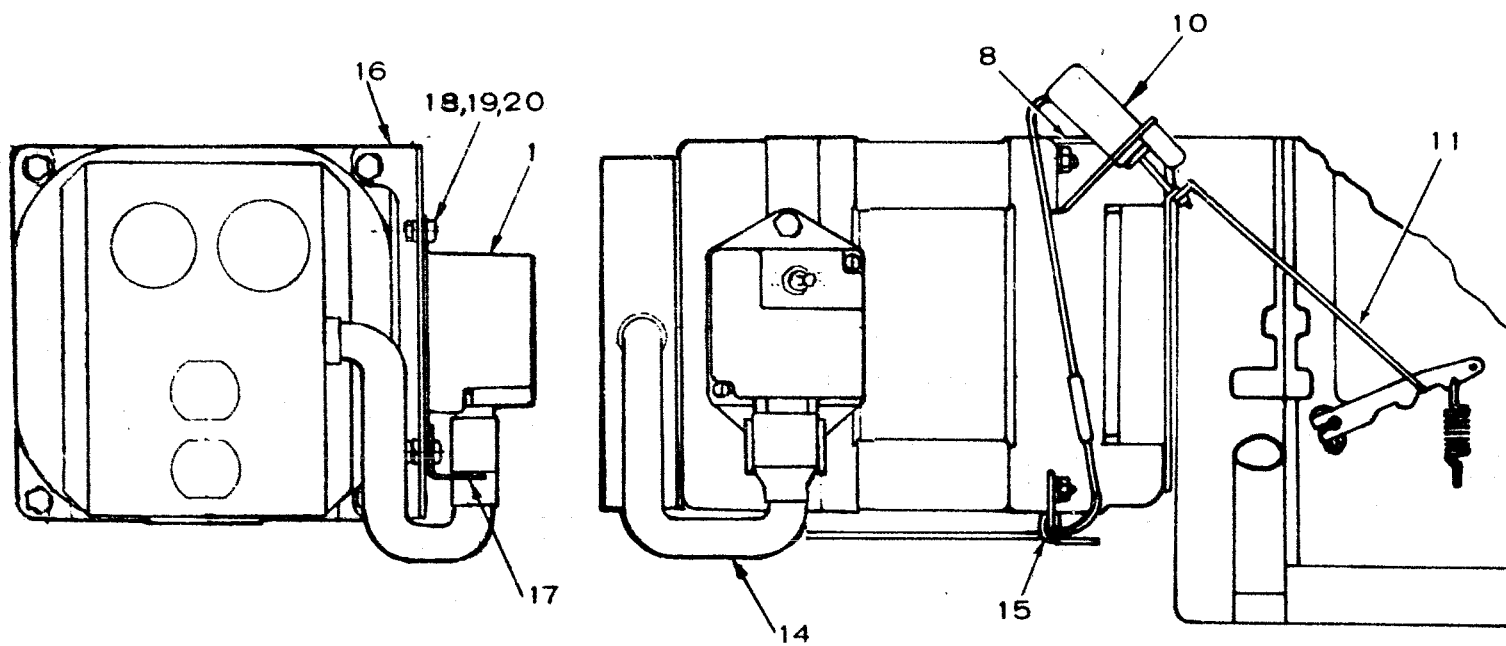

IDLE-MATIC CONTROL — OPTIONAL

REF NO.	PART NUMBER	PART DESCRIPTION	QUANTITY USED									
			A	B	C	D	E	F	G	H	J	
1	150-1491	Sensor Assembly, Speed Control (Includes Parts Marked *)		1	1	1	1	1	1			
2	301-3798	Plate, Base - Sensor Assembly*		1	1	1	1	1	1			
3	301-3791	Cover, Speed Sensor Assembly*		1	1	1	1	1	1			
4	300-1185	Printed Circuit Board - Sensor Assembly (See Separate Group for Components)*		1	1	1	1	1	1			
5	812-0065	Screw, Machine - Round Head (#6-32 x 5/8")*		4	4	4	4	4	4			
6	850-0020	Washer, Lock - Spring (#6)*		4	4	4	4	4	4			
7	526-0003	Washer, Flat (11/64" ID x 3/8" OD x 1/32" Thk)		2	2	2	2	2	2			
8	307-1392	Bracket, Solenoid Mounting		1	1	1						
9	307-1393	Bracket, Solenoid Mounting					1	1	1			
10	307-1391	Solenoid		1	1	1	1	1	1			
11	307-1403	Link, Solenoid to Carburetor		1	1							
12	307-1400	Link, Solenoid to Carburetor				1						
13	307-1394	Link, Solenoid to Carburetor					1	1	1			
14	HARNESS, WIRING											
	338-0944	PC Spec D, PE, PF, PG, PH Spec A and B		1	1	1	1	1	1			
	338-0904	PC Begin Spec E, PE, PF, PG, PH, PK Begin Spec C		1	1	1	1	1	1			
15	332-0820	Tie, Cable		2	2	2	2	2	2			
16	307-1406	Bracket, Sensor Mounting		1	1	1	1	1	1			
17	301-3870	Bracket, Plug Retainer		1	1	1	1	1	1			
18	800-0004	Screw, Cap - Hex Head (1/4-20 x 5/8")		2	2	2	2	2	2			
19	850-0040	Washer, Lock - Spring (1/4")		2	2	2	2	2	2			
20	862-0001	Nut, Hex (1/4-20)		2	2	2	2	2	2			
21	508-0190	Bushing, Strain Relief - PC Begin Spec E, PE, PF, PG, PH, PK Begin Spec C		1	1	1	1	1	1			
* - Parts Included in 150-1491 Sensor Assembly.												

SUPPLEMENT INDEX FOR "P" SERIES - 919-0305

SUPPLEMENT NO.	DATE	FICHE LOCATION
919-1023	06/78	1E3
919-1025	06/78	1E5

919-1023(9-77)
Supplementary Parts List

These Parts apply to the "P" Series Generator Sets Operators Manual and Parts Catalog 919-0305 Beginning Spec F. Also Contractor Models Listed Below Beginning Spec F. Use these Parts in addition or in place of those listed in Main Parts Catalog.

GENERATING SET DATA TABLE

DESCRIPTION	QUANTITY USED										
	A	B	C	D	E	F	G	H	J	K	
PF =				X							
PH =						X					
PK =							X				
CONSTRUCTOR'S MODELS											

GENERATOR GROUP

REF NO.	PART NUMBER	PART DESCRIPTION	QUANTITY USED										
			A	B	C	D	E	F	G	H	J	K	
6	220-2955	Stator Assembly, Wound		1	1								

RECEPTACLE BOX GROUP (60 HERTZ)

REF NO.	PART NUMBER	PART DESCRIPTION	QUANTITY USED									
			A	B	C	D	E	F	G	H	J	
1	BOX ASSEMBLY, RECEPTACLE											
	323-1070	Begin Spec F				1		1	1			
	323-0944	Constructor's Sets				1		1	1			
	BOX RECEPTACLE											
4	301-3824	With Holes for One 15 Amp, 125 Volt Duplex Receptacle, one 30 Amp, 125/250 Volt Twistlock Receptacle, two 15 Amp Circuit Breakers and two 30 Amp Circuit Breakers (Constructor's Sets)				1		1	1			
7A	301-1070	With Holes for two 15 Amp, 125 Volt Duplex Receptacles and four 15 Amp Circuit Breakers - Begin Spec F				1		1	1			
8	RECEPTACLE, OUTPUT - DUPLEX											
	323-0383	Constructor's Sets				1		1	1			
	323-0383	Begin Spec F				2		2	2			
12	RECEPTACLE, OUTPUT - TWISTLOCK											
	323-0943	Constructor's Sets				1		1	1			
16	SCREW, MACHINE - ROUNDHEAD											
	812-0061	Constructor's Sets				3		3	3			
	812-0061	Begin Spec F				2		2	2			
17	STRAP, GROUND											
	323-0869	Constructor's Sets				1		1	1			
	323-0869	Begin Spec F				2		2	2			
18	BREAKER, CIRCUIT											
	320-0540	Begin Spec F				4		4	4			
	320-0540	Constructor's Sets				2		2	2			
	320-0543	Constructor's Sets				2		2	2			
22	332-0941	Tie, Cable - Constructor's Sets				1		1	1			

919-1025
SUPPLEMENTARY PART LIST (2-78)

Parts in this list apply to the newly introduced PM model. This model is very similar to the discontinued PH model. Use these parts in place of or in addition to those listed in the quantity used column F in the main parts catalog 919-0305. Parts that are similar in appearance are not illustrated.

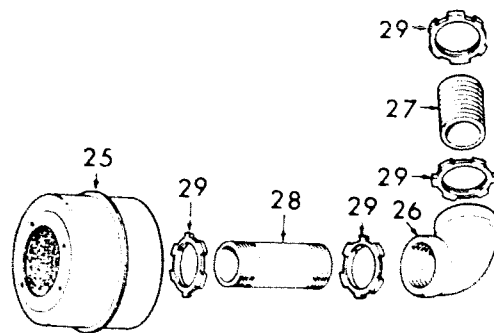

ENGINE AND CARRYING FRAME GROUP

REF. NO.	PART NO.	PART DESCRIPTION	QTY. USED
1	100-1567	Engine, 16 Horsepower (Briggs and Stratton model 326431) (Refer to Manufacturer for Component Parts)	1
25	155-1564	Muffler, Exhaust	1
26	505-0041	Elbow, Pipe - Exhaust (1" x 90°)	1
27	505-0004	Nipple, Pipe - Exhaust (1 x 1½")	1
28	505-0086	Nipple, Pipe - Exhaust (1 x 2½")	1
29	331-0053	Nut, Locking (1")	4

Operation specifications for the new PM model (Briggs and Stratton model 326431) are the same as those currently shown for the PH model except for displacement and cylinder bore.

PM displacement is 32.04 cubic inches and cylinder bore is 3.56 inches.

SPECIAL PARTS LIST INDEX FOR FORM NO. 717-0303

MODEL	SPEC.	DATED	FICHE LOCATION
1.0PD-1P	1A	09/01/79 ***	2 A1
1.0PD-3P	1A	09/01/79 ***	2 A1
1.0PD-53BP	1A	09/01/79 ***	2 A3
1.0PD-53CP	1A	09/01/79 ***	2 A3
1.2PD-1P	1A	09/01/79 ***	2 A5
1.2PD-3P	1A	09/01/79 ***	2 A5
1.6PE-53BP	1A	09/01/79 ***	2 A7
1.6PE-53CP	1A	09/01/79 ***	2 A7
2.0PE-1P	1A	09/01/79 ***	2 A9
2.0PE-3P	1A	09/01/79 ***	2 A9
2.5PF-53AP	1A	09/01/79 ***	2 A11
2.5PF-53BP	1A	09/01/79 ***	2 A11
2.5PF-53CP	1A	09/01/79 ***	2 A13
3.0PF-3P	1A	09/01/79 ***	2 A13
3.5PF-3P	1A	09/01/79 ***	2 B1
3.7PG-53BP	1A	09/01/79 ***	2 B1
3.7PG-53CP	1A	09/01/79 ***	2 B3
4.0PG-3P	1A	09/01/79 ***	2 B3
4.5PG-3P	1A	09/01/79 ***	2 B5
4.5PH-53AP	1A	09/01/79 ***	2 B5
4.5PH-53BP	1A	09/01/79 ***	2 B7
4.5PH-53CP	1A	09/01/79 ***	2 B7
4.5PH-57P	1A	09/01/79 ***	2 B9
5.0PH-3P	1A	09/01/79 ***	2 B9
5.5PH-3P	1A	09/01/79 ***	2 B11
6.0PH-3P	1A	09/01/79 ***	2 B11
3.7PG-53AP	1B	09/01/79 ***	2 B13
3.7PG-53BP	1B	09/01/79 ***	2 B13
3.7PG-53CP	1B	09/01/79 ***	2 C1
4.5PG-3P	1B	09/01/79 ***	2 C1
1.2PD-1P	1C	09/01/79 ***	2 C3
1.6PE-53BP	1C	09/01/79 ***	2 C3
1.6PE-53CP	1C	09/01/79 ***	2 C5
2.0PE-1P	1C	09/01/79 ***	2 C5
2.5PF-53BP	1C	09/01/79 ***	2 C7
2.5PF-53CP	1C	09/01/79 ***	2 C7
3.0PF-3P	1C	09/01/79 ***	2 C9
3.7PG-53BP	1C	09/01/79 ***	2 C9
3.7PG-53CP	1C	09/01/79 ***	2 C11
3.7PK-53BP	1C	09/01/79 ***	2 C11
3.7PK-53CP	1C	09/01/79 ***	2 C13
3.7PN-53BP	1C	09/01/79 ***	2 C13
3.7PN-53CP	1C	09/01/79 ***	2 D1
4.5PG-3P	1C	09/01/79 ***	2 D1
4.5PH-53BP	1C	09/01/79 ***	2 D3
4.5PH-53CP	1C	09/01/79 ***	2 D3
4.5PM-53BP	1C	09/01/79 ***	2 D5
4.5PM-53CP	1C	09/01/79 ***	2 D5
4.5PM-57P	1C	09/01/79 ***	2 D7
5.5PH-3P	1C	09/01/79 ***	2 D7
5.5PM-3P	1C	09/01/79 ***	2 D9
1.4PC-53BP	1D	09/01/79 ***	2 D9
1.4PC-53CP	1D	09/01/79 ***	2 D11
1.7PC-1P	1D	09/01/79 ***	2 D11

SPECIAL PHOTO LIST INDEX FOR FORM NO. 717-0000

MODEL	SPEC.	DATED	FICHE LOCATION
1.7PC-3P	1D	09/01/79 ***	2 D13
1.4PC-53BP	1E	09/01/79 ***	2 D13
1.4PC-53CP	1E	09/01/79 ***	2 E1
1.7PC-1P	1E	09/01/79 ***	2 E1
1.7PC-1P	1F	09/01/79 ***	2 E3
2.0PE-1P	1F	09/01/79 ***	2 E3
3.0PF-1P	1F	09/01/79 ***	2 E5
3.0PF-3P	1F	09/01/79 ***	2 E5
4.5PK-1P	1F	09/01/79 ***	2 E7
4.5PK-3P	1F	09/01/79 ***	2 E7
5.5PH-1P	1F	09/01/79 ***	2 E9
5.5PH-3P	1F	09/01/79 ***	2 E9
5.5PM-1P	1F	09/01/79 ***	2 E11
5.5PM-3P	1F	09/01/79 ***	2 E11
4.0PG-3P	8000A	09/01/79 ***	2 E13
1.7PC-1P	8000F	09/01/79 ***	2 E13
2.0PE-1P	8000F	09/01/79 ***	2 F1
3.0PF-3P	8000F	09/01/79 ***	2 F1
4.5PK-3P	8000F	09/01/79 ***	2 F3
5.5PM-3P	8000F	09/01/79 ***	2 F3
2.0PE-1P	8200A	09/01/79 ***	2 F5
3.0PF-3P	8200A	09/01/79 ***	2 F5
4.5PG-3P	8200B	09/01/79 ***	2 F7
2.0PE-1P	8200C	09/01/79 ***	2 F7
3.0PF-3P	8200C	09/01/79 ***	2 F9
1.7PC-1P	8200D	09/01/79 ***	2 F9
1.7PC-1P	8200E	09/01/79 ***	2 F11
1.7PC-1P	8200F	09/01/79 ***	2 F11
2.0PE-1P	8200F	09/01/79 ***	2 F13
3.0PF-1P	8200F	09/01/79 ***	2 F13
4.5PK-1P	8200F	09/01/79 ***	2 G1
5.5PH-1P	8200F	09/01/79 ***	2 G1
5.5PM-1P	8200F	09/01/79 ***	2 G3
2.0PE-1P	9900A	09/01/79 ***	2 G3
3.0PF-3P	9900A	09/01/79 ***	2 G5
4.0PG-3P	9900A	09/01/79 ***	2 G5
5.0PH-3P	9900A	09/01/79 ***	2 G7
6.0PH-3P	9900A	09/01/79 ***	2 G7
1.7PC-1P	9900D	09/01/79 ***	2 G9
2.0PE-1P	13033A	09/01/79 ***	2 G9
3.0PF-3P	13034A	09/01/79 ***	2 G11
4.0PG-3P	13034A	09/01/79 ***	2 G11
2.0PE-1P	13570A	09/01/79 ***	2 G13
1.5PC-1P	13570D	09/01/79 ***	2 G13
3.0PF-3P	13571A	09/01/79 ***	3 A1
4.0PG-3P	13571A	09/01/79 ***	3 A1
4.0PK-3P	13571A	09/01/79 ***	3 A3
5.0PH-3P	13571A	09/01/79 ***	3 A3
1.2PD-1P	14000A	09/01/79 ***	3 A5
2.0PE-1P	14000A	09/01/79 ***	3 A5
3.0PF-3P	14000A	09/01/79 ***	3 A7
5.5PH-3P	14000A	09/01/79 ***	3 A7
4.5PG-3P	14000B	09/01/79 ***	3 A9
1.7PC-1P	14000D	09/01/79 ***	3 A9

SPECIAL PARTS LISTS INDEX FOR FORM NO. 919-0305

MODEL	SPEC.	DATED	FICHE LOCATION
3.0PF-3P	14680A	09/01/79 ***	3 A11
5.5PH-3P	14696A	09/01/79 ***	3 A11
4.5PG-3P	14696B	09/01/79 ***	3 A13
3.0PF-3P	14697A	09/01/79 ***	3 A13
2.0PE-1P	14752A	09/01/79 ***	3 B1
3.0PF-3P	14753A	09/01/79 ***	3 B1
5.5PH-3P	14754A	09/01/79 ***	3 B3
4.5PG-3P	14754B	09/01/79 ***	3 B3
1.2PD-1P	15150A	09/01/79 ***	3 B5
1.2PD-1P	15581C	09/01/79 ***	3 B5
1.2PC-1P	15581D	09/01/79 ***	3 B7
1.2PC-1P	15581E	09/01/79 ***	3 B7
3.0PF-3P	15582A	09/01/79 ***	3 B9
3.0PF-3P	15582C	09/01/79 ***	3 B9
1.7PC-1P	15582D	09/01/79 ***	3 B11
1.7PC-1P	15582E	09/01/79 ***	3 B11
4.0PG-3P	15583A	09/01/79 ***	3 B13
4.0PK-3P	15583A	09/01/79 ***	3 B13
4.0PK-3P	15583C	09/01/79 ***	3 C1
4.0PN-3P	15583C	09/01/79 ***	3 C1
2.0PE-1P	15985A	09/01/79 ***	3 C3
2.0PE-1P	15985C	09/01/79 ***	3 C3
1.5PC-1P	15985D	09/01/79 ***	3 C5
1.5PC-1P	15985E	09/01/79 ***	3 C5
3.0PF-3P	15986A	09/01/79 ***	3 C7
4.0PG-3P	15987A	09/01/79 ***	3 C7
5.0PH-3P	15987A	09/01/79 ***	3 C9
5.0PH-3P	15995A	09/01/79 ***	3 C9
2.0PE-1P	15998A	09/01/79 ***	3 C11
4.0PG-3P	15999A	09/01/79 ***	3 C11
3.0PF-3P	16036A	09/01/79 ***	3 C13
5.5PH-3P	16690A	09/01/79 ***	3 C13
4.5PG-3P	16690B	09/01/79 ***	3 D1
2.5PF-53BP	17194A	09/01/79 ***	3 D1
4.5PH-53BP	17194A	09/01/79 ***	3 D3
1.4PC-53BP	17194D	09/01/79 ***	3 D3
1.7PC-1P	17196E	09/01/79 ***	3 D5
1.6PE-53CP	17197C	09/01/79 ***	3 D5
2.5PF-53BP	17197C	09/01/79 ***	3 D7
2.5PF-53CP	17197C	09/01/79 ***	3 D7
3.0PF-3P	17197C	09/01/79 ***	3 D9
3.7PG-53CP	17197C	09/01/79 ***	3 D9
3.7PK-53CP	17197C	09/01/79 ***	3 D11
4.5PH-53BP	17197C	09/01/79 ***	3 D11
4.5PH-53CP	17197C	09/01/79 ***	3 D13
4.5PM-53BP	17197C	09/01/79 ***	3 D13
4.5PM-53CP	17197C	09/01/79 ***	3 E1
1.4PC-53BP	17197E	09/01/79 ***	3 E1
1.4PC-53CP	17197E	09/01/79 ***	3 E3
2.5PF-53BP	17210C	09/01/79 ***	3 E3
3.0PF-3P	17249C	09/01/79 ***	3 E5
2.5PF-53BP	17251C	09/01/79 ***	3 E5
4.5PH-53BP	17251C	09/01/79 ***	3 E7
4.5PM-53BP	17251C	09/01/79 ***	3 E7

SPECIAL PARTS LISTS INDEX FOR FORM NO. 919-0305

MODEL	SPEC.	DATED	FICHE LOCATION
5.5PH-3P	17251C	09/01/79 ***	3 E9
5.5PM-3P	17251C	09/01/79 ***	3 E9
2.0PE-1P	17288C	09/01/79 ***	3 E11
1.7PC-1P	17288E	09/01/79 ***	3 E11
2.0PE-1P	17748C	09/01/79 ***	3 E13
3.0PF-3P	17748C	09/01/79 ***	3 E13
1.7PC-1P	17748E	09/01/79 ***	3 F1
4.5PK-3P	17749C	09/01/79 ***	3 F1
5.5PH-3P	17749C	09/01/79 ***	3 F3
3.0PF-3P	17796C	09/01/79 ***	3 F3
4.0PK-3P	17796C	09/01/79 ***	3 F5
5.0PH-3P	17829C	09/01/79 ***	3 F5
5.0PM-3P	17829C	09/01/79 ***	3 F7
6.5PM-3P	17829C	09/01/79 ***	3 F7
1.6PE-53CP	18084C	09/01/79 ***	3 F9
2.2PE-1P	18084C	09/01/79 ***	3 F9
3.5PF-3P	18085C	09/01/79 ***	3 F11
4.5PK-3P	18086C	09/01/79 ***	3 F11
4.5PN-3P	18086C	09/01/79 ***	3 F13
6.0PH-3P	18087C	09/01/79 ***	3 F13
6.0PM-3P	18087C	09/01/79 ***	3 G1
3.0PF-3P	18180F	09/01/79 ***	3 G1
4.5PK-3P	18180F	09/01/79 ***	3 G3
5.5PH-3P	18180F	09/01/79 ***	3 G3
5.5PM-3P	18180F	09/01/79 ***	3 G5
3.0PF-3P	18444F	09/01/79 ***	3 G5
4.5PK-3P	18444F	09/01/79 ***	3 G7
5.5PH-3P	18444F	09/01/79 ***	3 G7
5.5PM-3P	18444F	09/01/79 ***	3 G9
2.5PF-53CP	18713C	09/01/79 ***	3 G9
4.5PH-53CP	18714C	09/01/79 ***	3 G11
3.7PK-53CP	18716C	09/01/79 ***	3 G11
1.2PC-1P	19252F	09/01/79 ***	3 G13
1.7PC-1P	19252F	09/01/79 ***	3 G13
2.0PE-1P	19252F	09/01/79 ***	4 A1
2.2PE-1P	19252F	09/01/79 ***	4 A1
3.0PF-3P	19253F	09/01/79 ***	4 A3
4.5PK-3P	19254F	09/01/79 ***	4 A3
5.0PK-3P	19254F	09/01/79 ***	4 A5
6.0PM-3P	19271F	09/01/79 ***	4 A5
3.0PL-1P	19536F	09/01/79 ***	4 A7
3.7PK-53CP	19725C	09/01/79 ***	4 A7
3.5PF-3P	19761C	09/01/79 ***	4 A9
5.5PM-3P	19878F	09/01/79 ***	4 A9
3.0PF-3P	20042C	09/01/79 ***	4 A11
4.0PK-3P	20043C	09/01/79 ***	4 A11
4.0PN-3P	20043C	09/01/79 ***	4 A13
5.5PM-3P	20043C	09/01/79 ***	4 A13
6.0PM-3P	20085C	09/01/79 ***	4 B1
1.7PC-1P	20262F	09/01/79 ***	4 B1
2.2PE-1P	20263F	09/01/79 ***	4 B3
3.0PL-3P	20264F	09/01/79 ***	4 B3
5.0PK-3P	20270F	09/01/79 ***	4 B5
5.0PK-3E	20271F	09/01/79 ***	4 B5

SPECIAL PARTS LIST INDEX FOR FORM NO. 717-0302

MODEL	SPEC.	DATED	FICHE LOCATION
6.5PM-3F	20272F	09/01/79 ***	4 B7
6.5PM-3E	20273F	09/01/79 ***	4 B7
5.0PN-3E	20624F	09/01/79 ***	4 B9
3.7PK-53BP	20673C	09/01/79 ***	4 B9